

**CREDAI**  
MANGALORE

**PADIL  
GATE**  
COMMERCIAL & RESIDENTIAL



Near Toyota Showroom, Alape Post, Padil, Mangalore



PRM/KA/RERA/1257/333/PR/200515/003396

# GROUND FLOOR PLAN





## TYPICAL FOURTH & FIFTH FLOOR PLAN

- 01: 3BHK :- 1455.00SFT
- 02: 2BHK :- 1432.00SFT
- 03: 3BHK :- 1380.00SFT
- 04: 2BHK :- 1369.00SFT
- 05: 3BHK :- 1569.00SFT

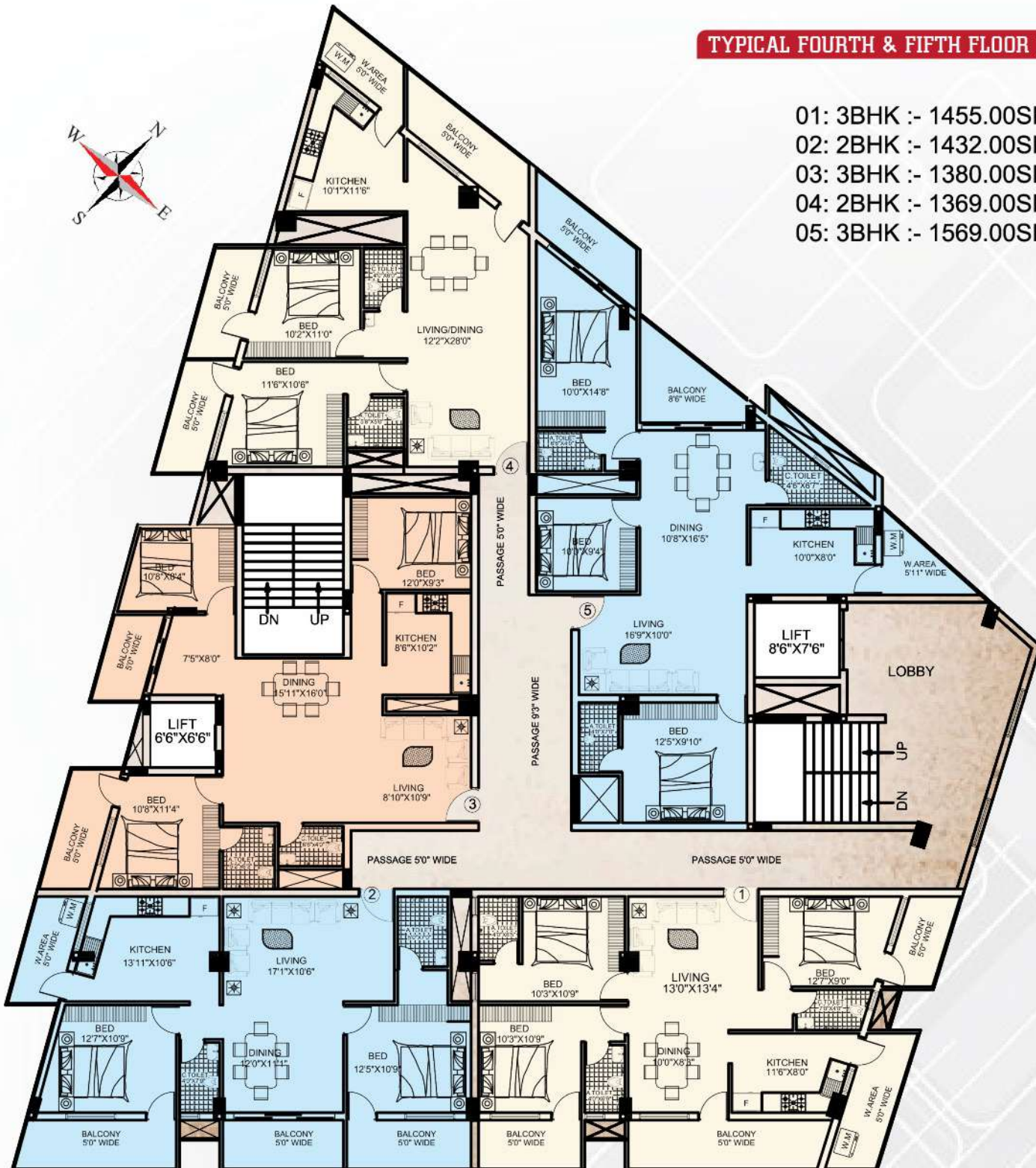



INTELLIGENT WORKSPACE



**PADIL  
GATE**  
COMMERCIAL & RESIDENTIAL

INSPIRATIONAL WORKSPACE





## COMPLETED PROJECTS



**SMART CITY**  
Thokkottu, Mangalore



**ROYAL PLANET**  
Jeppina Mogeru, Mangalore



**ROYAL PRIDE**  
Bolar, Mangalore



**SMART PLANET**  
Thokkottu, Mangalore



**MAX CITY**  
Rao & Rao Circle, Mangalore



**SAHAKARI SADANA**  
Near Rao & Rao Circle, Mangalore



**GARDEN CITY**  
Thokkottu, Mangalore



**GREEN CITY**  
Thokkottu, Mangalore



**CITY MAX**  
Vamanjoor, Mangalore

## ONGOING PROJECTS



**B.R. USHA KIRAN**  
Bolar, Mangalore



**TAMAM APARTMENTS**  
Krishnapura, Mangalore



**KINGDOM TOWER**  
Thokkottu, Mangalore



**KANKANADY GATE**  
Kankanady, Mangalore



**SMART CITY**  
Main Road, Bhatkal



## LOCATION MAP



PRM/KA/RERA/1257/333/PR/200515/003396

CONSTRUCTION



**MARK**  
CONSTRUCTION

By-Pass Road, Kankanady,  
Mangalore - 575002  
Mob: +91 98950 68222  
+91 98457 17100

### PROMOTORS:



**HINDUSTHAN BAWA**  
BUILDERS & DEVELOPERS



**TAMIM**  
BUILDERS & DEVELOPERS

### ARCHITECTS & ENGINEERS



**SHAFFI ASSOCIATES**

1st Floor, Al-Rahaba Plaza, Mangaluru  
Ph : 98451 91327, 0824 - 4288172  
e-mail : shaffiates@gmail.com

**FOR BOOKING CONTACT:**

**Mob: 9895068222 / 9482068222 / 9036916916**

DISCLAIMER : THIS BROCHURE IS COMCEPTUAL AND IS NOT A LEGAL DOCUMENT ALL MATERIALS, DIMENSIONS & DRAWINGS ARE APPROXIMATE. INFORMATION SUBJECT TO CHANGE WITHOUT NOTICE. ACTUAL USABLE FLOOR SPACE MAY VARY FROM THE STATED FLOOR PLAN DRAWINGS NOT TO SCALE. THE DEVELOPER RESERVES THE RIGHT TO MAKE REVISIONS.